

RFIB – Level 12, 30 St. Mary's

Axe

Client: Square Metre

Value: £1.2 million

Duration: 14 Weeks

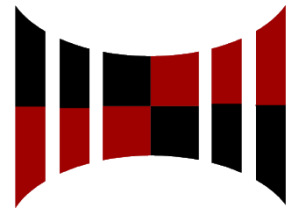

Metric Solutions Ltd

Metric Solutions secured its first project with Square Metre at London's iconic Gherkin building, undertaking the full Cat B M&E works on Level 12.

The D&B project scope included for full strip out and install of HVAC and electrical services, all within a tight 14-week programme.

Within the new HVAC services were Swegon AHU's, Mitsubishi Electric VRF, Ability Fan Coils, along with mods to the existing BMS, Sprinkler system and fire alarm.

Along with new HVAC services, a brand-new Dali Controlled lighting system by Delmatic along with Scene setting services were installed within the modular offices to complete a stylish and sleek design.

The project was managed by our in-house M&E site team delivering this prestigious project on time, allowing the client to move into their new office space on schedule and extremely happy with Metric Solutions workmanship.

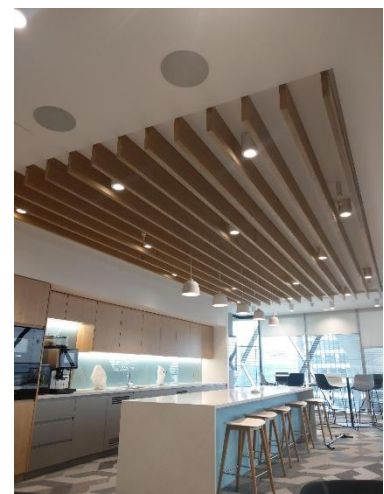
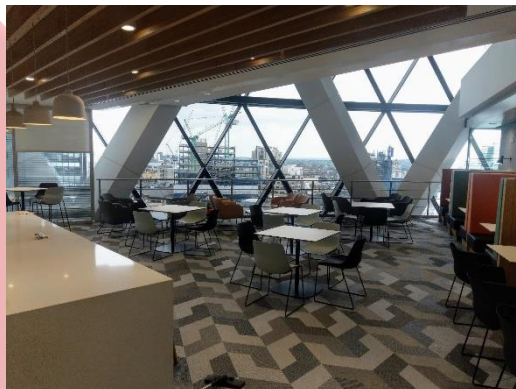
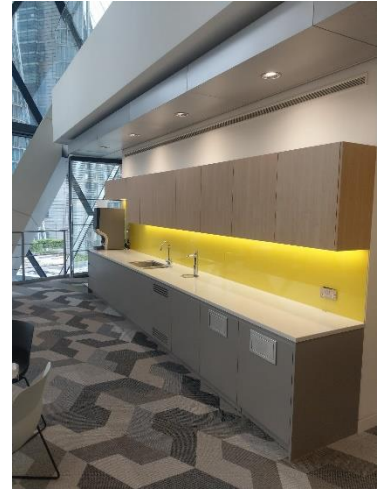

Mechanical & Electrical Installation

Metric Solutions Ltd

Unit 21 Maple Park, Essex Road, Hoddesdon, Hertfordshire, EN11 0EX

T: 020 8363 2707 E: info@metricssolutions.co.uk W: www.metricssolutions.co.uk